

Adelaide Airport is the major gateway to South Australia. Around 9 million passengers use the airport each year and this is expected to continue to grow. The airport complex employs several thousand people and attracts many more visitors. Parafield Airport is Australia's premier flight training aerodrome, producing skilled pilots for numerous international airlines.

As we are entering a carbon-constrained future, we are conscious of the impact that the aviation industry has on greenhouse gas emissions and the contribution from airport operations. We are also conscious that climate change and carbon risk management are becoming an essential aspect of operating a sustainable business over the long-term.

We are therefore committed to employing principles of resource efficiency in our operations, planning and ongoing infrastructure development and in the procurement of goods and services. This approach will, in turn, help airlines and other tenants to reduce their impact.

Adelaide Airport Ltd is a member of Airports Council International and is committed to Airports Carbon Accreditation – Adelaide and Parafield Airports were the first two airports in Australia to achieve Level 1 Accreditation for carbon mapping. Further, we are committed to measuring and reducing our carbon footprint on an ongoing basis and encouraging partners, suppliers and other users of the airport to do likewise.

Electricity consumption accounts for over 85% of AAL's carbon inventory, so it makes sense to focus on maximising energy efficiency opportunities. AAL's internal Energy for Change Group oversees an energy reduction program and assesses initiatives for subsequent implementation. AAL considers this an important aspect of its future economic viability as well as being a responsible business practice.

In order to identify suitable projects, we will continue to seek local research and development partnerships where opportunities arise.

More specific details on carbon reduction and climate change adaptation activities and objectives can be found in our Airport Environmental Strategies.



Mark Young  
Managing Director  
June 2014

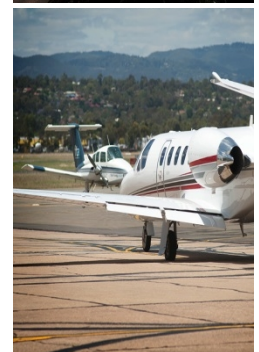
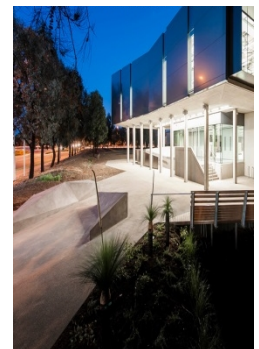
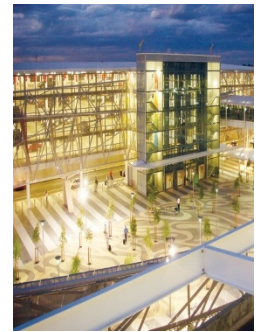

Document ID	Revision Status	Revision Date	Authorised by	Page
1530	Approved Revision : 3.0	08/09/2013	Managing Director	Page 1 of 1